



LED OUTDOOR WALL SCNCE

LWS26 series

► **DESIGN** - LED OUTDOOR WALL SCNCES has a modern, multipurpose design and a stylish look with efficient lighting. The clear seeded glass shade with a 180° beam angle filled with air bubbles emits a luxurious glow. It is designed to operate on 120V or 120-277V circuits and provides smooth triac dimming capabilities ranging from 10% to 100%.

► **VARIETY** - The fixture comes in 13-inch, 18-inch and 24-inch and available in White or Black finishes.

► **COLOR SELECTABLE** - You can choose either a 3000K warm white, 4000K cool white or 5000K daylight color temperature.

► **RGBW** - Indicated fixtures has RGBW design with manual selection switch on the bottom of the fixture. You can easily select Red, Green, Blue, Warm White and Daylight White.

► **APPLICATION** - The fixture is rated for Wet Locations, making it perfect for indoor and outdoor projects such as decks, front doors, porches, patios, corridors, walkways, or any other common areas. Durable waterproof housing resistant to rust and impact can be used outdoors in all weather conditions.

► **ADVANTAGES** - With a lifespan of 50,000 hours, these fixtures are made to last decades under normal operation! ASD provides a 5-year limited warranty along with ETL certification to guarantee top quality products and safety!

► **OPTIONS:**

► **MODELS WITH PHOTOCELL** - The built-in Dusk to Dawn Photocell will automatically turn the fixture on/off depending on the time of day.

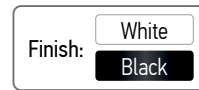

PRODUCT PRESENTATION:

Model	Size	Power	Voltage	Dimming	Lumens	CCT	Finish	Dimensions	Certification
LWS26S									
ASD-LWS26S-13D12BK	13inch	12 W	120V	Triac	566lm	3,000/4,000/5,000 K	Black	4-3/4" x 2-1/2" x 13-3/4"	ETL(5032534)
ASD-LWS26S-13D12WH	13inch	12 W	120V	Triac	566lm	3,000/4,000/5,000 K	White	4-3/4" x 2-1/2" x 13-3/4"	ETL(5032534)
ASD-LWS26S-18D12BK	18inch	12 W	120V	Triac	495lm	3,000/4,000/5,000 K	Black	4-3/4" x 2-1/2" x 17-15/16"	ETL(5032534)
ASD-LWS26S-18D12WH	18inch	12 W	120V	Triac	495lm	3,000/4,000/5,000 K	White	4-3/4" x 2-1/2" x 17-15/16"	ETL(5032534)
ASD-LWS26S-MV-24D20CC-BK	24inch	20 W	120-277V	Triac	581lm	3,000/4,000/5,000 K	Black	4-3/4" x 2-15/16" x 24"	ETL(5032534)
ASD-LWS26S-MV-24D20CC-WH	24inch	20 W	120-277V	Triac	581lm	3,000/4,000/5,000 K	White	4-3/4" x 2-15/16" x 24"	ETL(5032534)
LWS26S-PC WITH PHOTOCELL									
ASD-LWS26S-13N12BK-PC	13inch	11.5 W	120V	-	566lm	3,000/4,000/5,000 K	Black	4-3/4" x 2-1/2" x 13-3/4"	ETL(5032534)
ASD-LWS26S-18N12BK-PC	18inch	12 W	120V	-	495lm	3,000/4,000/5,000 K	Black	4-3/4" x 2-1/2" x 17-15/16"	ETL(5032534)
ASD-LWS26S-24N12BK-PC	24inch	12 W	120V	-	605lm	3,000/4,000/5,000 K	Black	4-3/4" x 2-15/16" x 24"	ETL(5032534)
LWS26-RGBW									
ASD-LWS26-13N9AC-RGBW-BK	13 inch	8.5 W	120-277V	manual switch	243lm	Red-Green-Blue-2,700K-6,500K	Black	4-3/4" x 2-7/8" x 13-3/4"	ETL(5032534)
ASD-LWS26-18N9AC-RGBW-BK	18 inch	8.5 W	120-277V	manual switch	190lm	Red-Green-Blue-2,700K-6,500K	Black	4-3/4" x 2-7/8" x 17-15/16"	ETL(5032534)

For most up-to-date spec sheets please refer to asd-lighting.com



LED OUTDOOR WALL SCENCE

LWS26 series

TECHNICAL PARAMETERS:

Model	Work environment	Operating temperature	Power factor	Beam Angle	Surge protection	Housing	Lens	CRI
LWS26S								
ASD-LWS26S-13D12BK	Wet location	-40°F to 113°F (-40°C to 45°C)	>0,9	180°	1kV	Aluminum	Clear seeded glass	>80
ASD-LWS26S-13D12WH	Wet location	-40°F to 113°F (-40°C to 45°C)	>0,9	180°	2kV	Aluminum	Clear seeded glass	>80
ASD-LWS26S-18D12BK	Wet location	-40°F to 113°F (-40°C to 45°C)	>0,9	180°	1kV	Aluminum	Clear seeded glass	>80
ASD-LWS26S-18D12WH	Wet location	-40°F to 113°F (-40°C to 45°C)	>0,9	180°	1kV	Aluminum	Clear seeded glass	>80
ASD-LWS26S-MV-24D20CC-BK	Wet location	-40°F to 113°F (-40°C to 45°C)	>0,9	180°	1kV	Aluminum	Clear seeded glass	>80
ASD-LWS26S-MV-24D20CC-WH	Wet location	-40°F to 113°F (-40°C to 45°C)	>0,9	180°	1kV	Aluminum	Clear seeded glass	>80
LWS26S-PC WITH PHOTOCELL								
ASD-LWS26S-13N12BK-PC	Wet location	-4°F to 113°F (-20°C to 45°C)	>0,9	180°	2kV	Aluminum	Clear seeded glass	>80
ASD-LWS26S-18N12BK-PC	Wet location	-4°F to 113°F (-20°C to 45°C)	>0,9	180°	2kV	Aluminum	Clear seeded glass	>80
ASD-LWS26S-24N12BK-PC	Wet location	-4°F to 113°F (-20°C to 45°C)	>0,9	180°	1kV	Aluminum	Clear seeded glass	>80
LWS26-RGBW								
ASD-LWS26-13N9AC-RGBW-BK	Wet location	-40°F to 113°F (-40°C to 45°C)	>0,9	87°	2kV	Aluminum	Clear seeded glass	>80
ASD-LWS26-18N9AC-RGBW-BK	Wet location	-40°F to 113°F (-40°C to 45°C)	>0,9	93°	2kV	Aluminum	Clear seeded glass	>80

DIMMING COMPATIBLE CONTROLS:

Brand	Lutron		Leviton
Models	MACL-153MLH-WH	DVCL-153PR	R02-DW6HD-2RW
	STCL-153PH-WH	P-PKG1W	R00-RNL06-0TW
	PD-6WCL-WH-R		R68-06674-P0T
			DSL06

PACKAGE CONTENTS:

Description	Quantity
LED Outdoor Wall Scence	1
Mounting plate (A)	1
Wire nut (B)	3
Photocell cap (C) only for PC models	1
Mounting screw (D)	2
Self-tapping screw (E)	2
Black screw (F)	4
Anchor (G)	2
Box	1



INSTALLATION GUIDE

IMPORTANT SAFETY INFORMATION:

Please read all the instructions below before installation!

- ▶ Make sure that the supply voltage corresponds to the rated product voltage.
- ▶ The product must be installed by a qualified electrician in accordance with the National Electrical Code and corresponding local codes.
- ▶ If the product is damaged, do not use it.

⚠ WARNING

Risk of personal injury – read and follow all warnings and installation instructions. Keep or give to the owner for future reference.

Risk of cuts: Wear gloves to prevent cuts or abrasions when removing from carton, handling, installing, and maintaining this product.

Risk of electric shock: This product must be installed in accordance with the applicable installation code by a person familiar with the construction and operation of the product and the hazards involved.

Risk of Fire: Minimum 194°F supply conductors. Consult a qualified electrician to ensure correct branch circuit conductor.

ASD® assumes no responsibility for claims arising out of improper or careless Installation or handling of this product.

BUILT-IN PHOTOCELL INFORMATION

Specifications	
Input power	120 Vac, 60 Hz
Light level to turn ON	30 – 150 lux (2.8 - 14 fc)
Light level to turn OFF	200 – 800 lux (18.6-74.4 fc)
Operating temperature	-4°F to 113°F (-20°C to 45°C)

The dusk-to-dawn sensor automatically turns the fixture off during daylight hours.

INSTALLATION STEPS:

1. Remove the mounting plate by unscrewing the black screws from both sides of the fixture. Unscrew the screws from the back plate of the fixture. Attach the mounting plate to the outlet box using mounting screws. In models with photocell option remove the photocell cap to make the dusk-to-dawn sensor operate. Choose needed color temperature by adjusting switch position.
2. Slide the glass through the bracket at the base of the fixture until fully inserted. Attach the glass by using screws on the back plate of the fixture. Connect the wires: Black to Black, White to White, Ground to Ground.
3. Secure the connection with wire nuts. Attach the fixture to the mounting plate using black screws on both sides. Before tightening the screws, align the holes of both the fixture and the mounting plate to ensure a solid fit.

For outdoor locations please use silicone (not included).

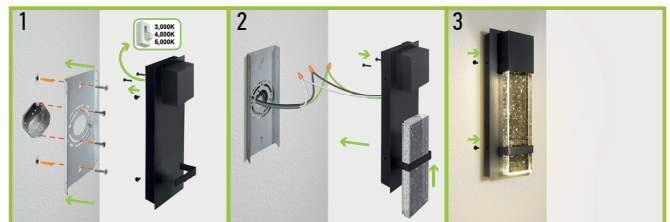

For most up-to-date spec sheets please refer to asd-lighting.com



LED OUTDOOR WALL SCNCE

LWS26 series

ORDERING INFORMATION

Model	Product dimensions	Weight	Pcs. Per carton	Carton size	Carton weight	UPC	GTIN 14
LWS26S							
ASD-LWS26S-13D12BK	4-3/4" x 2-1/2" x 13-3/4"	4.6 lbs(2.1kg)	2	15.94" x 6.69" x 12.01"	12.1 lbs	81012811512	10810128115121
ASD-LWS26S-13D12WH	4-3/4" x 2-1/2" x 13-3/4"	3.8 lbs(1.7kg)	2	15.94" x 6.69" x 12.01"	9.2 lbs	81019020098	10810190200985
ASD-LWS26S-18D12BK	4-3/4" x 2-1/2" x 17-15/16"	6.0 lbs(2.7kg)	2	20.08" x 6.69" x 12.01"	15.7 lbs	81012811513	10810128115138
ASD-LWS26S-18D12WH	4-3/4" x 2-1/2" x 17-15/16"	6.0 lbs(2.7kg)	2	20.08" x 6.69" x 12.01"	15.7 lbs	81012811718	10810128117187
ASD-LWS26S-MV-24D20CC-BK	4-3/4" x 2-15/16" x 24"	6.6 lbs(3.0kg)	2	26.18" x 6.69" x 12.99"	17.6 lbs	81012811259	10810128112595
ASD-LWS26S-MV-24D20CC-WH	4-3/4" x 2-15/16" x 24"	7.9 lbs(3.6kg)	2	26.18" x 6.69" x 12.99"	19.0 lbs	81019020088	10810190200886
LWS26S-PC WITH PHOTOCELL							
ASD-LWS26S-13N12BK-PC	4-3/4" x 2-1/2" x 133/4"	4.6 lbs(2.1kg)	2	15.94" x 6.69" x 12.01"	12.1 lbs	81012811719	10810128117194
ASD-LWS26S-18N12BK-PC	4-3/4" x 2-1/2" x 17-15/16"	6.0 lbs(2.7kg)	2	20.08" x 6.69" x 12.01"	15.7 lbs	81012811570	10810128115701
ASD-LWS26S-24N12BK-PC	4-3/4" x 2-15/16" x 24"	7.7 lbs(3.5kg)	2	26.18" x 6.69" x 12.99"	18.7 lbs	81019020089	10810190200893
LWS26-RGBW							
ASD-LWS26-13N9AC-RGBW-BK	4-3/4" x 2-7/8" x 13-3/4"	4.9 lbs(2.2kg)	2	15.94" x 6.69" x 12.99"	12.6 lbs	81012811474	20810128114749
ASD-LWS26-18N9AC-RGBW-BK	4-3/4" x 2-7/8" x 17-15/16"	6.2 lbs(2.8kg)	2	20.08" x 6.69" x 12.99"	17.2 lbs	81012811479	20810128114794

For most up-to-date spec sheets please refer to asd-lighting.com