



RISK OF FIRE AND ELECTRICAL SHOCK. FIXTURE MUST BE INSTALLED BY A QUALIFIED ELECTRICIAN ONLY IN ACCORDANCE WITH NATIONAL, LOCAL BUILDING AND ELECTRICAL CODES. DISCONNECT POWER AT ELECTRICAL PANEL BEFORE SERVICING.

SAFETY NOTES:

Installation should be performed only by qualified electrician.

- Make sure no voltage while installation.
- Connect cable wires according to wire labeling.
- Max current should not exceed 16A in one power feed in circuit.

WIRE DIAGRAM OF TRIPLE CIRCUITS FUNCTION

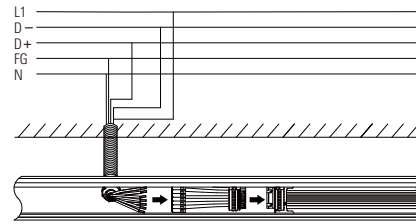

INSTALLATION ACCESSORY



Suspension Cord



Surfacing Mounting Kit

RAIL WITHOUT LINE JOINER

This versatile trunking rail module offers dual installation options to suit various lighting layout needs: Standalone Unit-Can be installed independently as a single-section solution for compact or individual lighting setups. End-Piece Configuration-Designed to seamlessly complete continuous lighting runs, ensuring a clean and integrated finish.

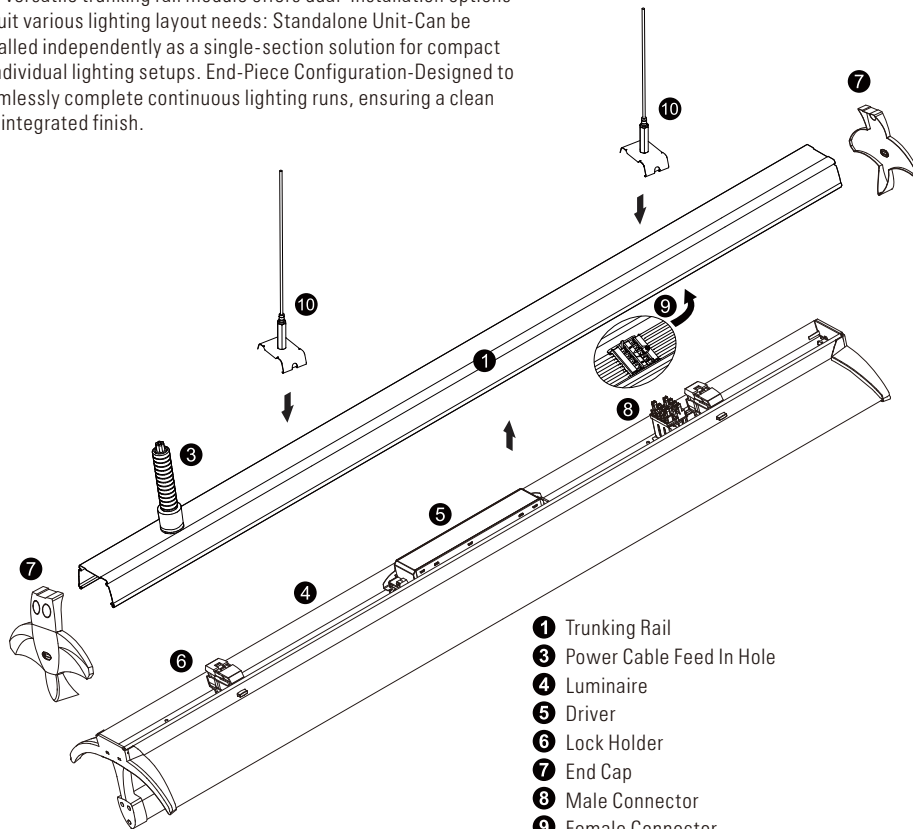

- 1 Trunking Rail
- 3 Power Cable Feed In Hole
- 4 Luminaire
- 5 Driver
- 6 Lock Holder
- 7 End Cap
- 8 Male Connector
- 9 Female Connector
- 10 Suspension Cord 10FT or Surface Kit

INDEPENDENT INSTALLATION

Step 1

Mounting Suspension Cord

Drill a hole on ceiling



Fix mounting hook into ceiling

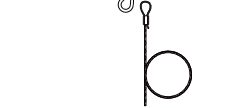

Adjust length of suspension cord:

- Press down Hexagon bolt
- Pull in/out cord to adjust length

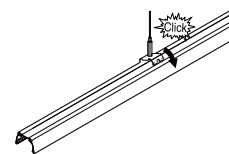

Click in mounting clip into trunking rail

Step 2

Connecting Power Supply

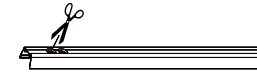

Cut the rubber cap to pass the power cable



Screw in the conduit gland

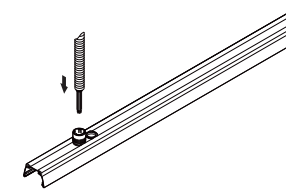

Put in conduit with cable inside and pull up conduit gland to lock



Connect wires according labeling on wires to feed in connector then connect to connector in trunking rail

Step 3

Mounting Luminaire

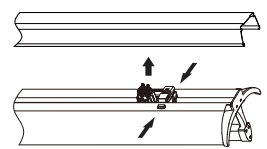

Make sure male & female connectors in right position then fix the luminaire to trunking rail



Push the sliding lock to lock the luminaire to trunking rail



ATTENTION: Install in accordance with national and local building and electrical codes.



RISK OF FIRE AND ELECTRICAL SHOCK. FIXTURE MUST BE INSTALLED BY A QUALIFIED ELECTRICIAN ONLY IN ACCORDANCE WITH NATIONAL, LOCAL BUILDING AND ELECTRICAL CODES. DISCONNECT POWER AT ELECTRICAL PANEL BEFORE SERVICING.

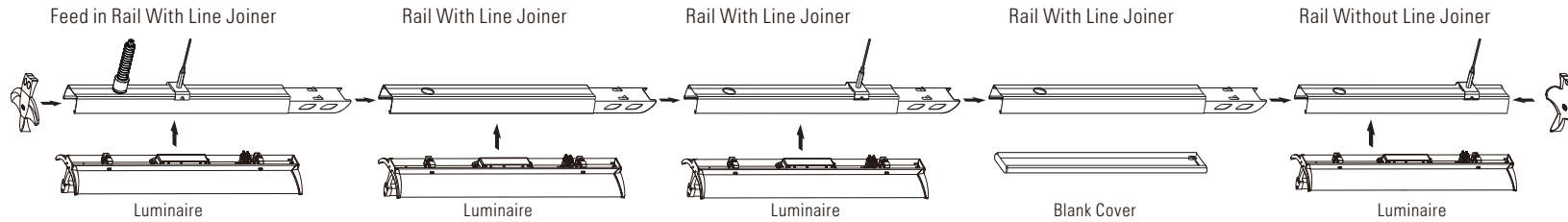

RAIL WITH LINE JOINER

This module is designed for the first and middle sections of continuous lighting runs. The integrated line joiner seamlessly connects adjacent light fixtures, ensuring a secure and uninterrupted installation.

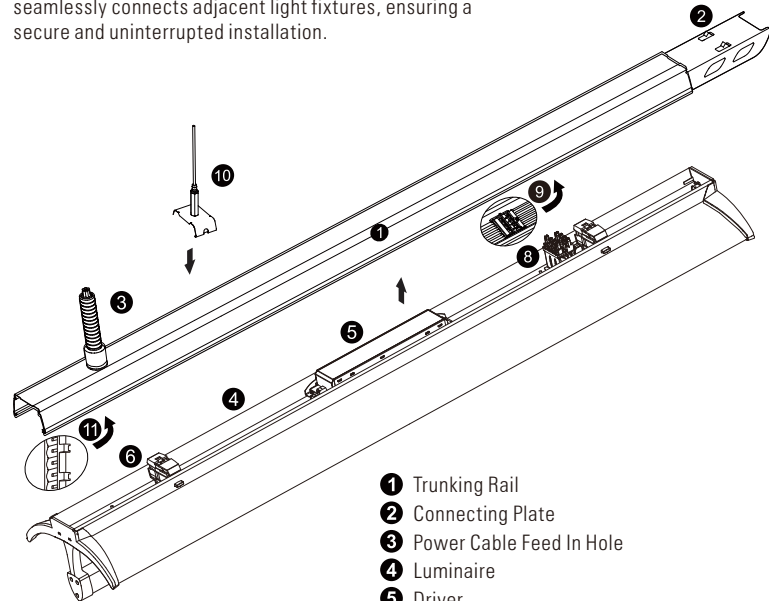

- 1 Trunking Rail
 - 2 Connecting Plate
 - 3 Power Cable Feed In Hole
 - 4 Luminaire
 - 5 Driver
 - 6 Lock Holder
 - 8 Male Connector
 - 9 Female Connector
 - 10 Suspension Cord 10FT or Surface Kit
 - 11 Definition of 5-core
- 5-Core trunking rail ① ② ③ ④ ⑤
L1 N D- PE D+

MULTIPLE LUMINAIRES CONNECTION

Step 1

Mounting Suspension Cord

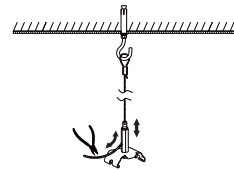

Adjust length of suspension cord:
a. Press down Hexagon bolt
b. Pull in/out cord to adjust length

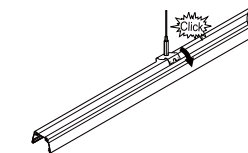

Click in mounting clip into trunking rail

Step 2

Connecting Power Supply

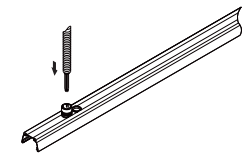

Put in conduit with cable inside and pull up conduit gland to lock



Connect wires according labeling on wires to feed in connector then connect to connector in trunking rail

Step 3

Connecting Trunking Rail

Both trunking rails should keep in perfect position then push to click

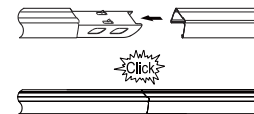

Step 4

Mounting Luminaire

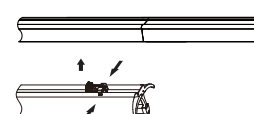

Make sure male & female connectors in right position then fix the luminaire to trunking rail

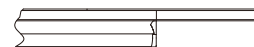

Step 5

Install Blank Cover (Optional)

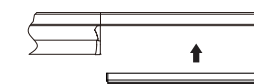

Designed for trunking systems where no luminaire is required. Equipped with an integrated stopper to block light emission.

SUSPENDED OR SURFACE MOUNTING DISTANCE

The maximum starting installation distance should be 2³/₅ ft, and the maximum distance between any two mounting points must not exceed 9⁴/₅ ft. Two suspension or surface distance options are provided below:

For a 4 ft trunking rail, two suspension cords or surface kits can be spaced up to 8 ft apart, provided that each is positioned at the midpoint of the trunking rail.

For an 8 ft trunking rail, it is recommended to use one suspension cord or surface kit per luminaire.



ATTENTION: Install in accordance with national and local building and electrical codes.